

ZONING

12 Attachment 4

ADDENDUM I MAP

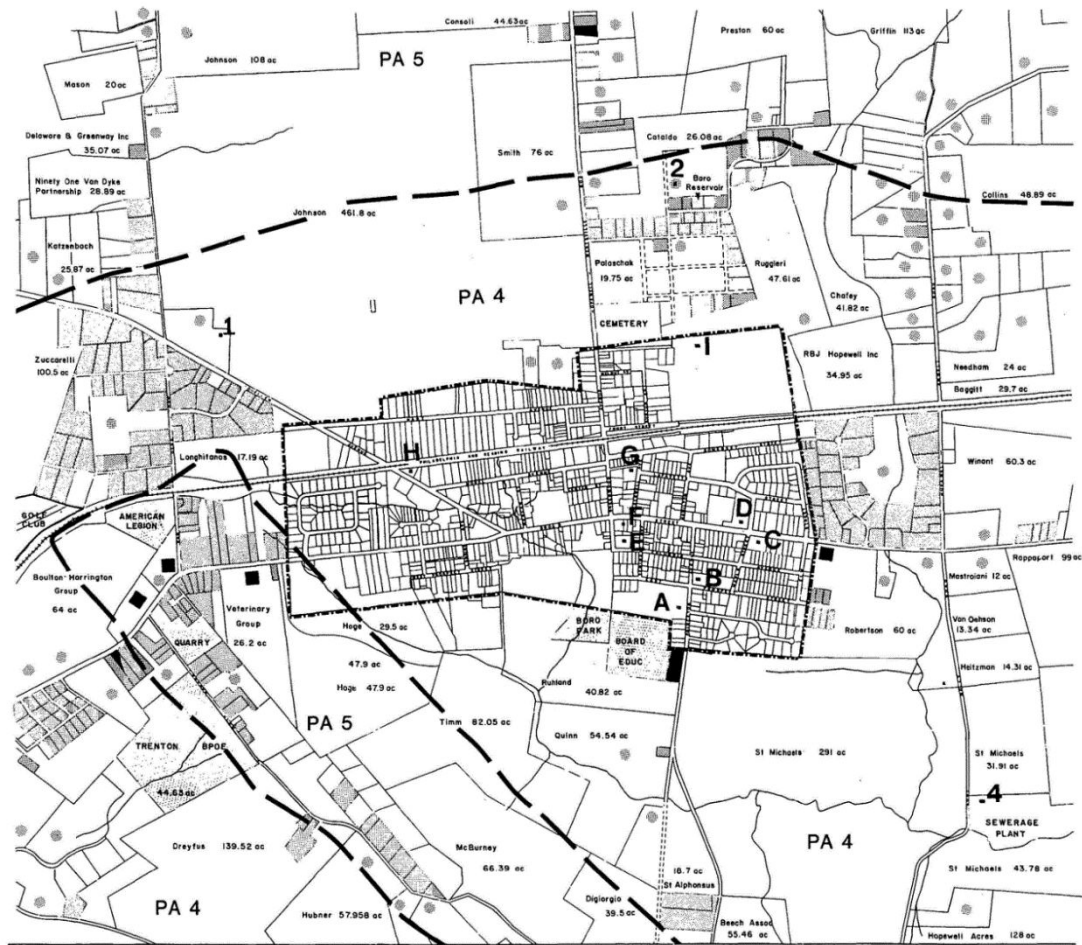

**THE BOROUGH OF HOPEWELL  
AND SURROUNDING AREA OF HOPEWELL TOWNSHIP  
MERCER COUNTY  
NEW JERSEY**

Base map revised September, 1998

CARL G. LINDBLOOM ASSOCIATES  
Borough Planning Consultant

1257/1258



STATE PLANNING AREAS  
NJ State Development and Redevelopment Plan  
PA 4 RURAL PLANNING AREA  
PA 5 ENVIRONMENTALLY SENSITIVE PLANNING AREA  
(Planning area boundaries are not site specific locations.)

EXISTING LAND USE 1996

- COMMERCIAL
- PUBLIC/SEMI-PUBLIC
- RESIDENTIAL
- OPEN SPACE (VACANT/ WOODED/ AGRICULTURAL)
- HOPEWELL BOROUGH

**ADDENDUM I MAP  
SHOWING THE  
"FIRST PRIORITY" LOCATIONS  
FOR  
WIRELESS COMMUNICATION  
ANTENNAS  
ON OR WITHIN EXISTING  
STRUCTURES  
WITHIN HOPEWELL BOROUGH  
& ALSO SHOWING OTHER  
EXISTING STRUCTURES  
NEAR THE BOROUGH**

<b>A - I</b>	Structures Within The Borough
<b>1 - 4</b>	Structures Near The Borough
Note: See Attached Table For Description Of Structures	

-3-

THIS BASE MAP WAS INCLUDED IN THE  
1997 HOPEWELL BOROUGH MASTER PLAN  
ADOPTED ON MARCH 5, 1997.  
THE MASTER PLAN INCLUDES  
AN ADDITIONAL MAP INDICATING  
THE EXISTING LAND USE IN THE BOROUGH.

Rev. Ord. Supp. 12/03