

**Figure 1.**  
**BUILDING SEPARATION DISTANCES**

---

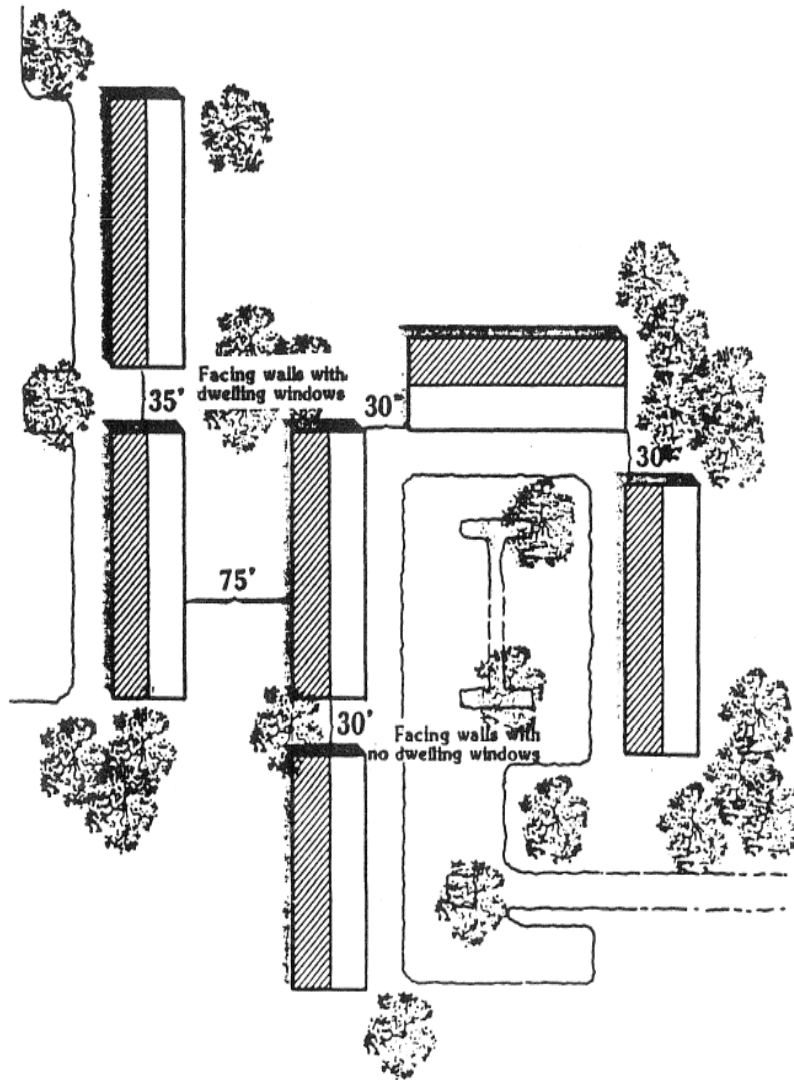
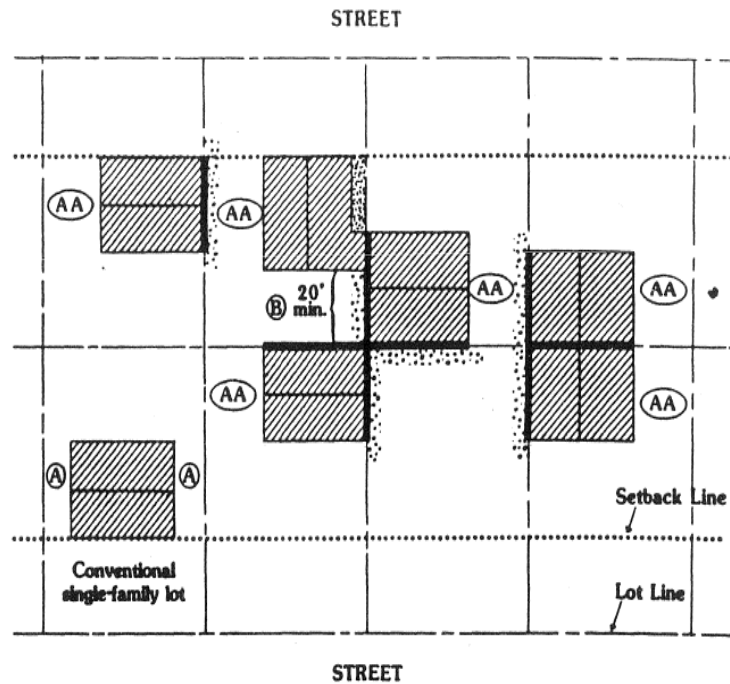





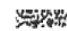

Figure 2.  
**THE REDUCED YARD DEVELOPMENT  
 DESIGN OPTION**



**Legend**

-  Dwelling wall within reduced yard. Contains no windows, openings or projections.
-  Common party wall
-  Normally required side yard
-  Side yard twice that normally required [§ 178-98B(3)]
-  Section § 178-98B(4) requirement
-  Easement required by § 178-98C(4)
-  Easement required by § 178-98C(5)