

UNIFIED DEVELOPMENT ORDINANCE

UDO Attachment 1

Township of Logan

EXHIBIT A  
Frontage Types, Planned Village Development

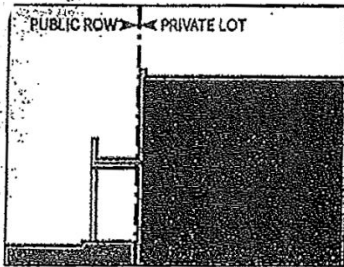

**A. Arcade:** the facade of a building with an attached colonnade. Balconies may overlap the sidewalk while the ground floor remains set at the lot line. This type is ideal for retail use, but only when the sidewalk is fully absorbed within the arcade so that a pedestrian cannot bypass it. An easement for private use of the right-of-way is usually required. To be useful, the arcade should be no less than 8 feet wide clear in all directions.

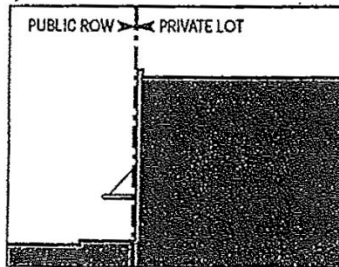

**B. Shopfront:** the facade is placed at or close to the right-of-way line, with the entrance at sidewalk grade. This type is conventional for retail frontage. It is commonly equipped with cantilevered shed roof or awning. The absence of a raised ground floor story precludes residential use on the ground floor facing the street, although this use is appropriate behind and above.

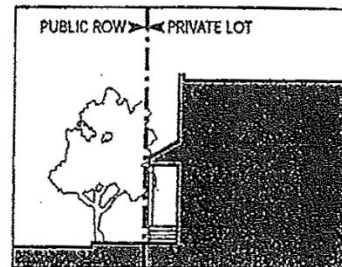

**C. Stoop:** the facade is placed close to the frontage line with the ground story elevated from the sidewalk, securing privacy for the windows. This type is suitable for ground floor residential uses at short setbacks. This type may be interspersed with the shopfront. A porch may also cover the stoop.

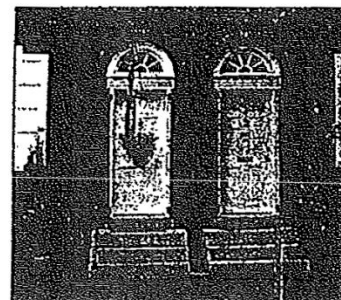
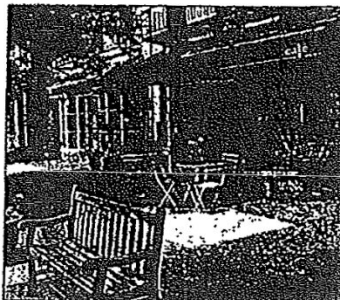
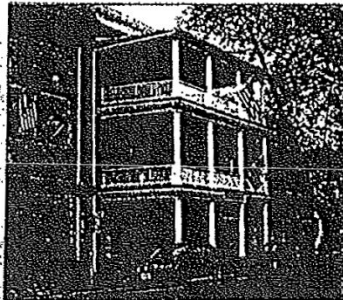

LOGAN CODE

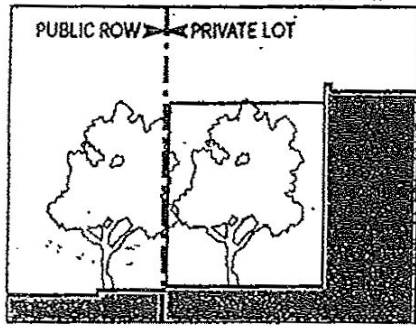

**D. Forecourt:** the facade is aligned close to the frontage line with a portion of it setback. The resulting forecourt is suitable for gardens, vehicular drop offs, and utility off loading. This type should be used sparingly and in conjunction with the stoops and shopfronts. A fence or wall at the property line may be used to define the private space of the yard. The court may also be raised from the sidewalk, creating a small retaining wall at the property line with entry steps to the court.

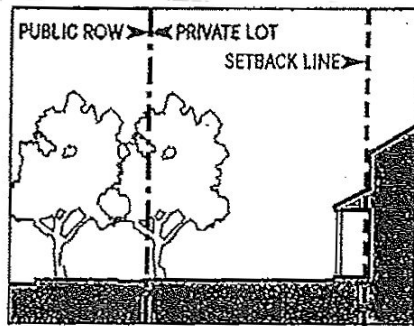

**E. Frontyard:** the facade is setback from the frontage line with a frontyard. An encroaching porch may also be appended to the facade. A great variety of porches designs are possible, but to be useful, none should be less than 8 feet deep and 12 feet wide. A fence or wall at the property line may be used to define the private space of the yard. The frontyard may also be raised from the sidewalk, creating a small retaining wall at the property line with entry steps to the yard.

