

ZONING

185 Attachment 14

Township of Hardyston

**Building Types Standards**  
[Added 7-2-2007 by Ord. No. 2007-09]

Fringe Residential

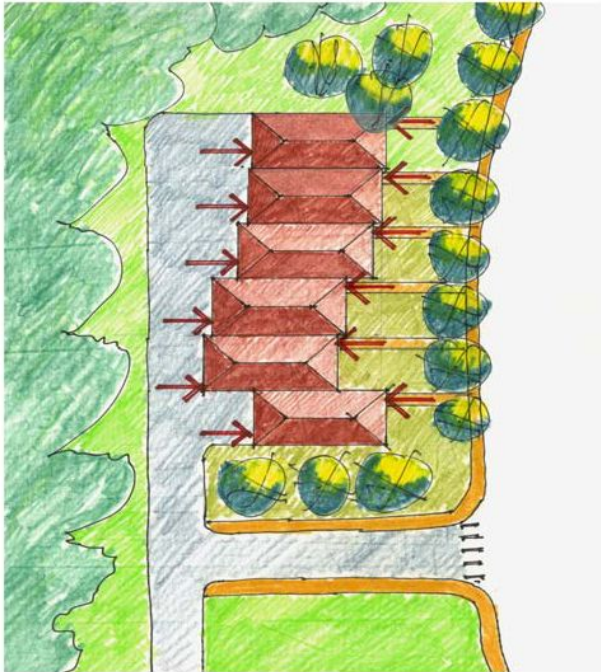

- Maximum number of units per building: 6
- Stagger units for visual privacy.
- Front and rear walls shall be exterior walls.
- At least one garaged parking space per unit.
- Use of alleys providing rear parking is encouraged.
- Garage doors fronting on public streets are discouraged.
- Parking, to the maximum extent feasible, shall not be located between the building line and street line.
- Principal entry of the building shall be oriented to the street.



# HARDYSTON CODE

Examples:



*Stratton Springs, Vt*  
Architects: Lemay + Youkel ©



*Storied Places, Mt-Tremblant, Qc, Canada*  
Architects: Lemay+Youkel ©



*Stratton Springs, Vermont*  
Architects: Lemay+Youkel ©

# ZONING

## Transitional Residential

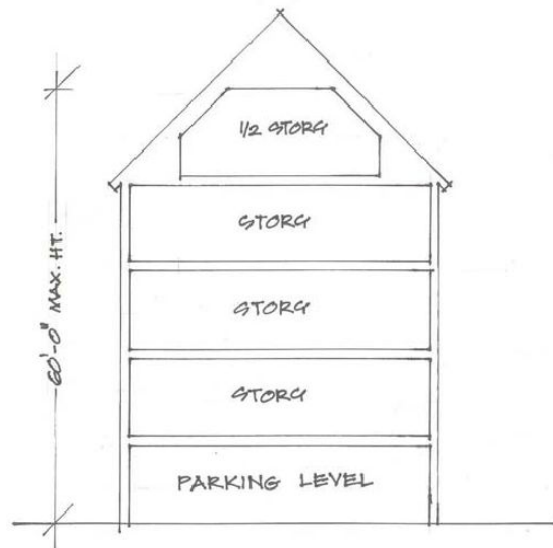
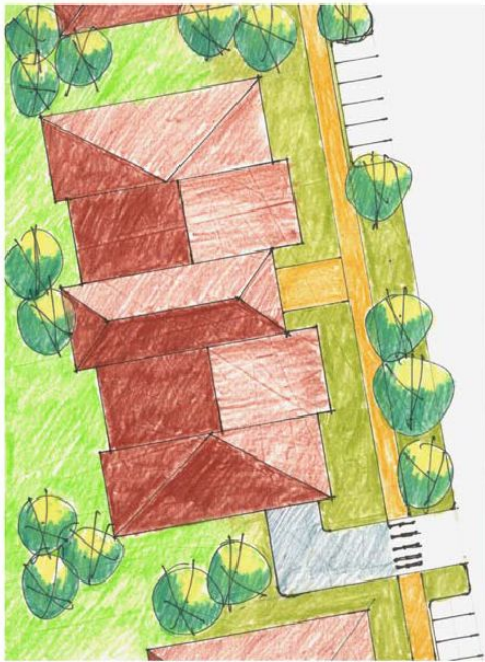

MAXIMUM HEIGHT- 3 1/2 HABITABLE STORIES/  
60 FEET OVER 1 PARKING LEVEL

Maximum Length: 200 Feet

Maximum Habitable Gross Floor Area: 120,000 Square Feet

## Examples:



Panache, Mt-Tremblant, Qc, Canada  
Architects: Lemay+Youkel ©

# HARDYSTON CODE



*Early Founders Lodge, Stratton, Vt  
Architects: Lemay + Youkel ©*



*Panache, Mt-Tremblant, Qc, Canada  
Architects: Lemay+Youkel ©*



*Panache, Mt-Tremblant, Qc, Canada  
Architects: Lemay+Youkel ©*



*Panache, Mt-Tremblant, Qc, Canada  
Architects: Lemay+Youkel ©*



*Bondurant, Mt-Tremblant, Qc, Canada  
Architects: Lemay+Youkel ©*

## ZONING

### Core Residential

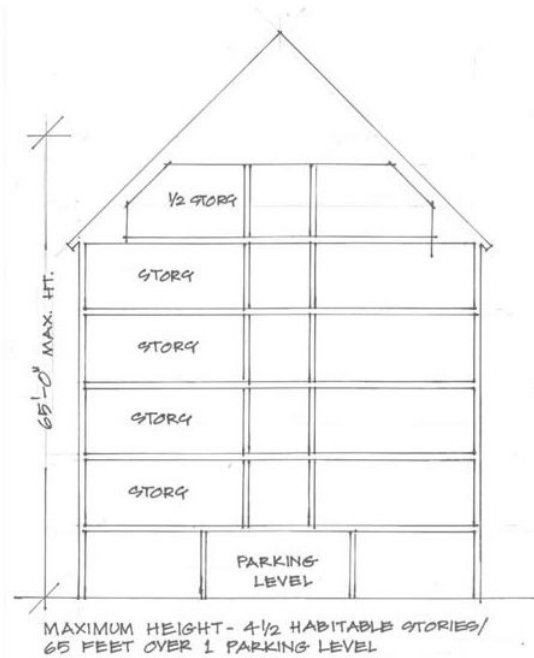
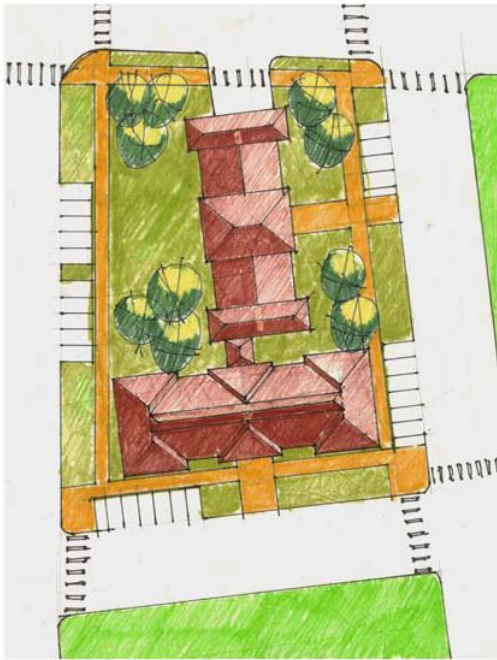

Maximum length: 200 feet

Maximum Habitable Gross Floor Area: 120,000 square feet

If developed as a "T" or "L" shaped building, the maximum length may be increased to 300' and the maximum habitable gross floor area may be increased to 200,000 square feet.

# HARDYSTON CODE

Examples:



*Founders Lodge, Stratton, Vermont  
Architects: Lemay+Youkel ©*



*Founders Lodge, Stratton, Vermont  
Architects: Lemay+Youkel ©*



*Bondurant, Mt-Tremblant, Qc, Canada  
Architects: Lemay+Youkel ©*

ZONING



*Founders Lodge, Stratton, Vt*  
*Architects: Lemay+Youkel ©*

# HARDYSTON CODE

Highway Business/Commercial

Examples:

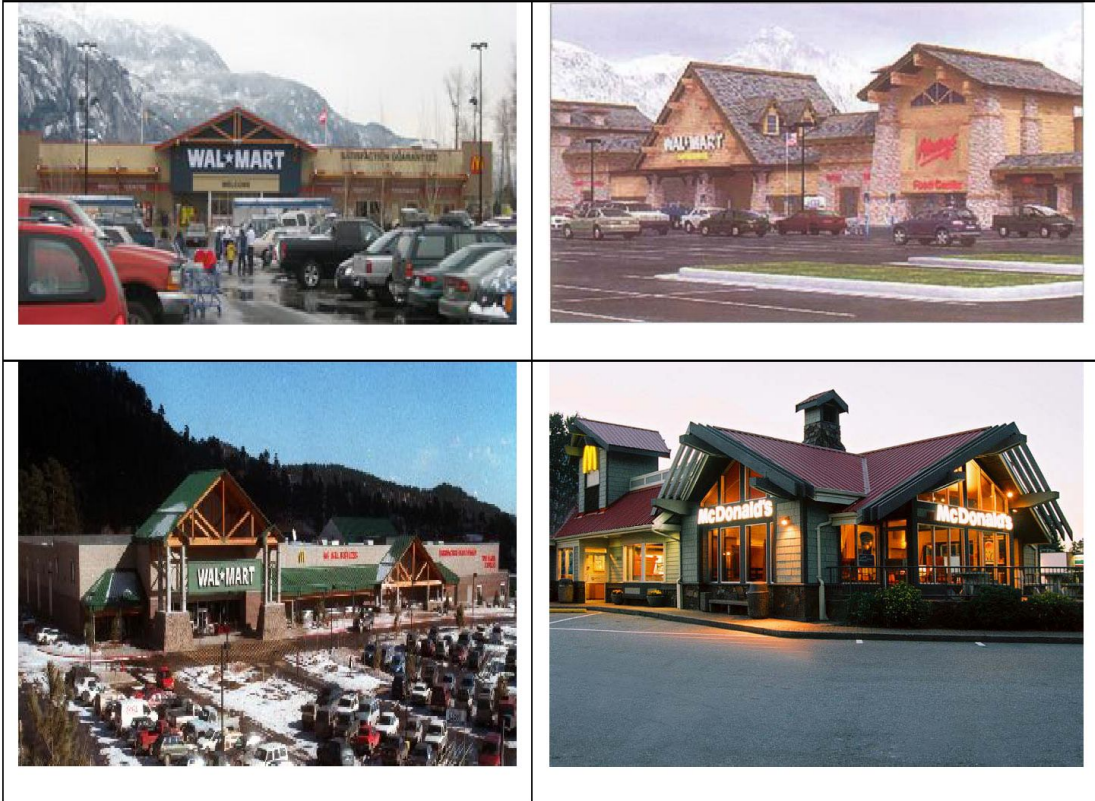



ZONING

Mixed-Use Village Core

Examples:

