

ZONING

Outlying Commercial District (OCD)  
Map #5

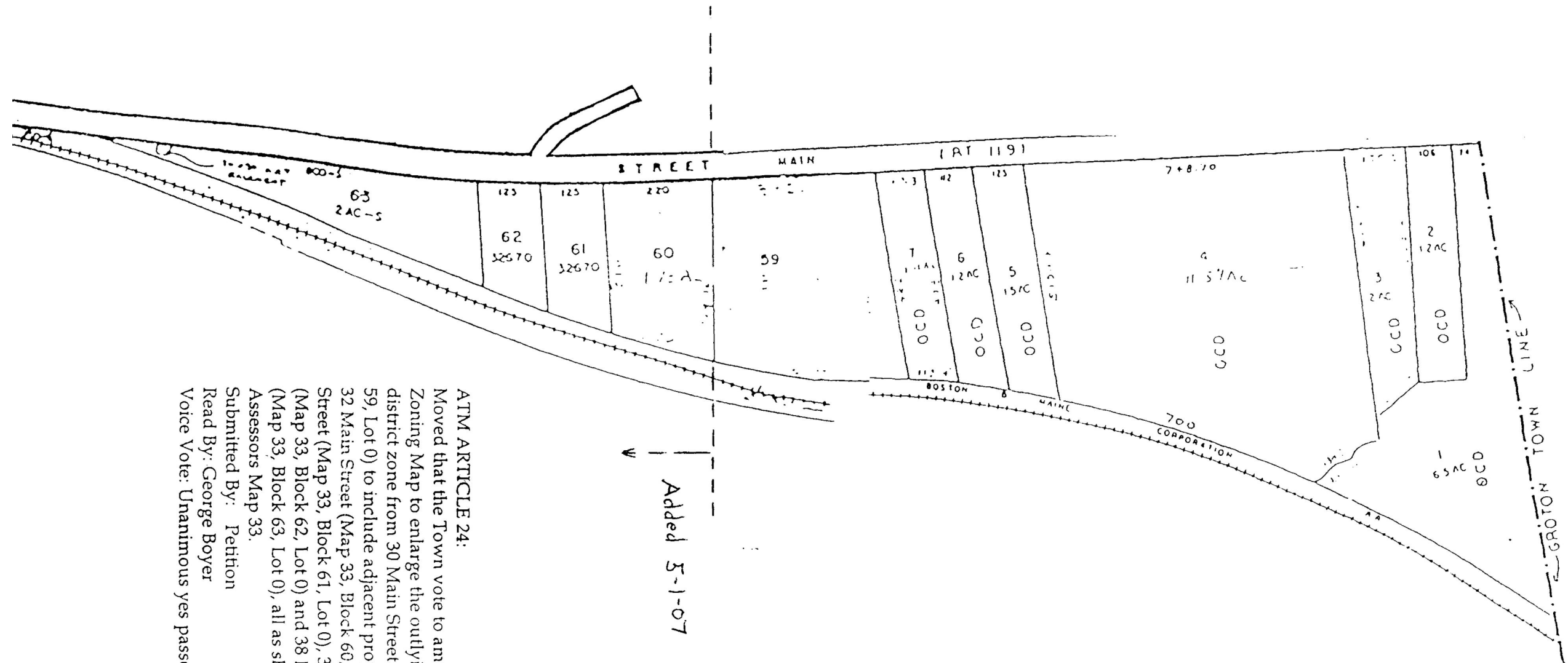

ATM ARTICLE 24:  
 Moved that the Town vote to amend the Town Zoning Map to enlarge the outlying commercial district zone from 30 Main Street (Map 33, Block 59, Lot 0) to include adjacent properties located 32 Main Street (Map 33, Block 60, Lot 0), 34 Main Street (Map 33, Block 61, Lot 0), 36 Main Street (Map 33, Block 62, Lot 0) and 38 Main Street (Map 33, Block 63, Lot 0), all as shown on Assessors Map 33.  
 Submitted By: Petition  
 Read By: George Boyer  
 Voice Vote: Unanimous yes passes

*Amended - Townsend Zoning Map - STM 1/89*

TOWNSEND ZONING BYLAW  
 Map # 5  
 January, 1989  
 Outlying Commercial District (OCD)  
 Reproduced from Assessors Maps # 33 & # 41

