

ZONING

305 Attachment 2

Appendix 2
Nonconforming Uses, Lots and Structures [see § 305-18C(6)]
[Added 7-10-2006 by Ord. No. 03-07]

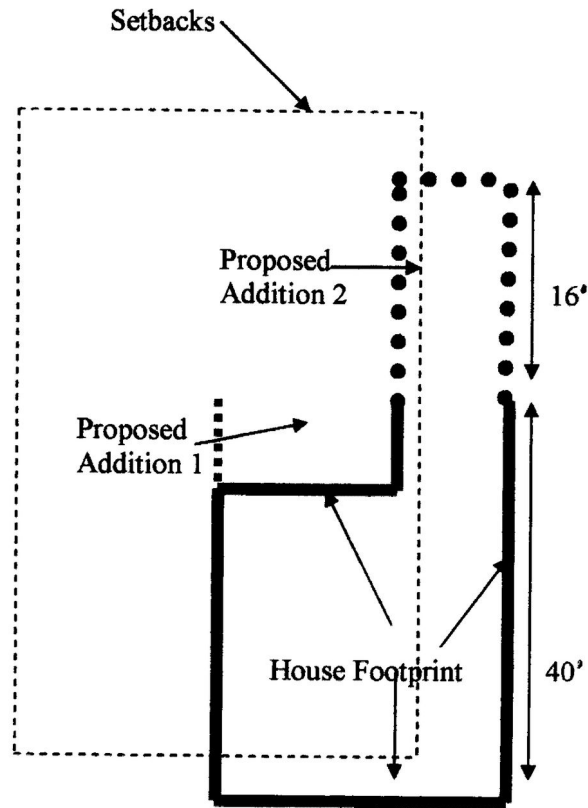

Proposed Addition #1 would be allowed by right, since all of the work area meets the required setback.

Proposed Addition #2 could be allowed through a special exception if its length is 16 feet or less and the distance between the property line and the structure is no less than 75% of the required setback.

If the existing structure and Addition #2 were both two stories, then it could be allowed through a special exception. If the existing structure was only one story, then the addition must also be one story.