

**ORDINANCE 2025-01**

**AN ORDINANCE OF THE BOROUGH OF BAY HEAD, COUNTY OF OCEAN, STATE OF NEW JERSEY, AMENDING AND SUPPLEMENTING CHAPTER 147 OF THE BOROUGH CODE OF THE BOROUGH OF BAY HEAD, ENTITLED "LAND USE" (ZONING MAP)**

**NOW, THEREFORE, BE IT ORDAINED**, by the governing body of the Borough of Bay Head, County of Ocean, State of New Jersey, as follows:

**SECTION 1.** The Borough Code of the Borough of Bay Head is hereby amended and supplemented so as to amend Chapter 147, entitled "Land Use" so as to amend §147-4 entitled "Zoning Maps; boundaries in its entirety so that it shall read as follows:

Under the power granted by the Municipal Land Use Law, N.J.S.A. 40:55D-1 et seq., the Borough of Bay Head hereby adopts an Official Zoning Map. The boundaries of the above zoning districts are hereby established as shown on said map, entitled "Zoning Map of the Borough of Bay Head," dated October 2024. This map is hereby made a part of this chapter. Where uncertainty exists as to any of the boundaries shown on said map, the following rules shall apply:

- A. Zone boundary lines are intended to follow the center line of streets, railroad rights-of-way, streams and lots or property lines as they exist on plats of record at the time of the passage of this chapter, unless such boundary lines are fixed by dimensions as shown on the Zoning Map
- B. In the unsubdivided land and where a zone boundary divides a lot, the location of such boundary, unless the same is indicated by dimensions shown on the map, shall be determined by the use of the scale appearing thereon.

**SECTION 2.** All ordinances or parts of ordinances inconsistent herewith are hereby repealed.

**SECTION 3.** If any section, subsection, sentence, clause, phrase or portion of this ordinance is for any reason held to be invalid or unconstitutional by a court of competent jurisdiction, such portion shall be deemed a separate, distinct and independent provision, and such holding shall not affect the validity of the remaining portions hereof.

**SECTION 4.** This ordinance shall take effect after second reading and publication as required by law.

**NOTICE OF PENDING ORDINANCE**

**NOTICE IS HEREBY GIVEN** that the foregoing ordinance was introduced and passed by the Borough Council on first reading at a meeting of the Borough Council of the Borough of Bay Head held on the 2<sup>nd</sup> day of January 2025, and will be considered for second reading and final passage at a regular meeting of the Borough Council to be held on the 3<sup>rd</sup> of February, at 7:00 p.m. at the Bay Head Municipal Building, located at 83 Bridge Avenue, Bay Head, New Jersey, at which time and place any persons desiring to be heard upon the same will be given the opportunity to be so heard.

**NOTICE OF ADOPTION**

**PUBLIC NOTICE IS HEREBY GIVEN** that the foregoing ordinance published herewith has been finally adopted by the Borough Council of the Borough of Bay Head, in the County of Ocean, New Jersey on February 3<sup>rd</sup>, 2024.

**ATTESTED TO BY:**

**APPROVED:**

  
\_\_\_\_\_  
**ANTOINETTE JONES, RMC, CMR**  
**BOROUGH CLERK**

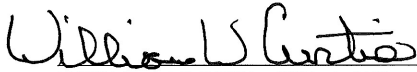
  
\_\_\_\_\_  
**WILLIAM W. CURTIS,**  
**MAYOR**

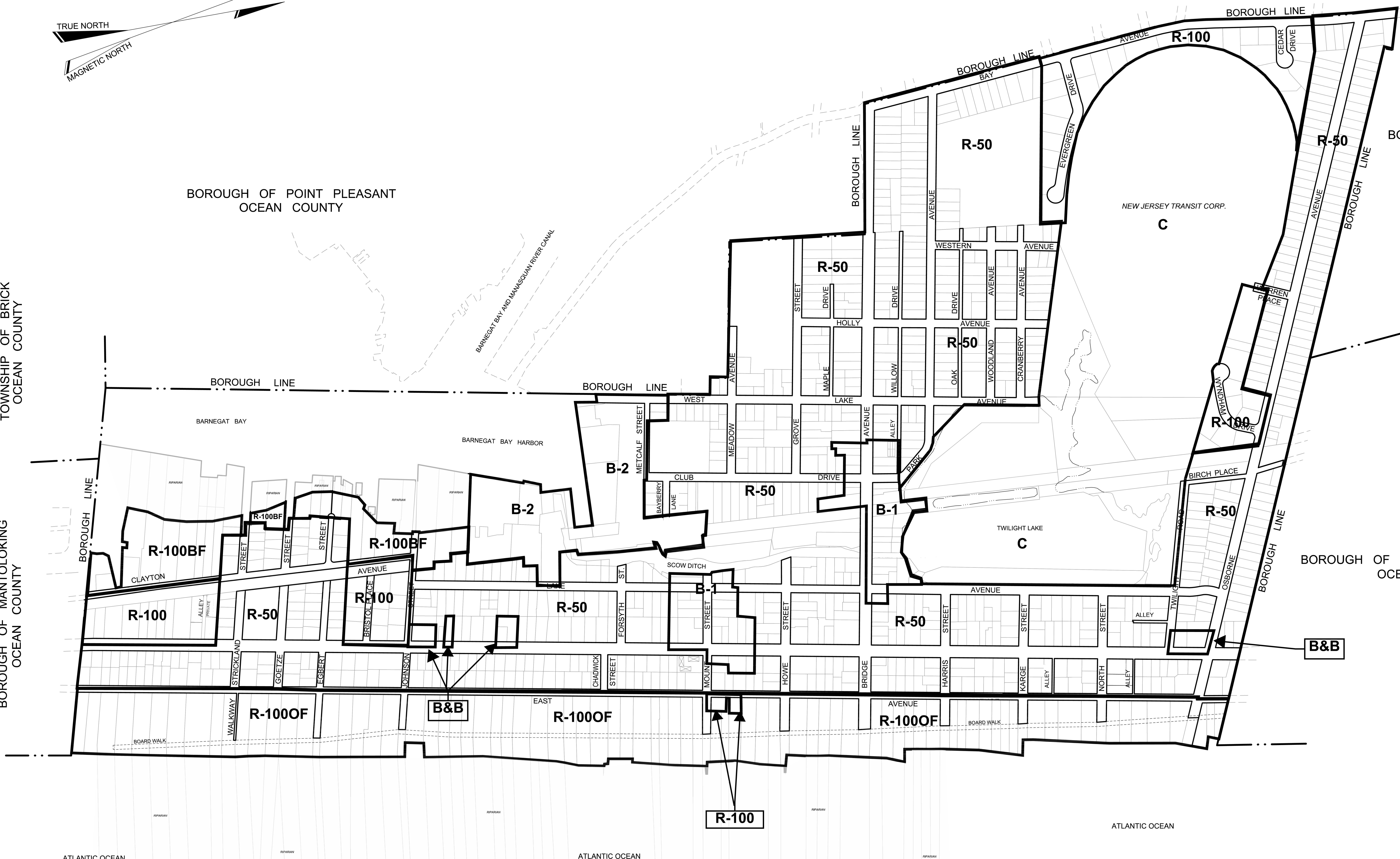
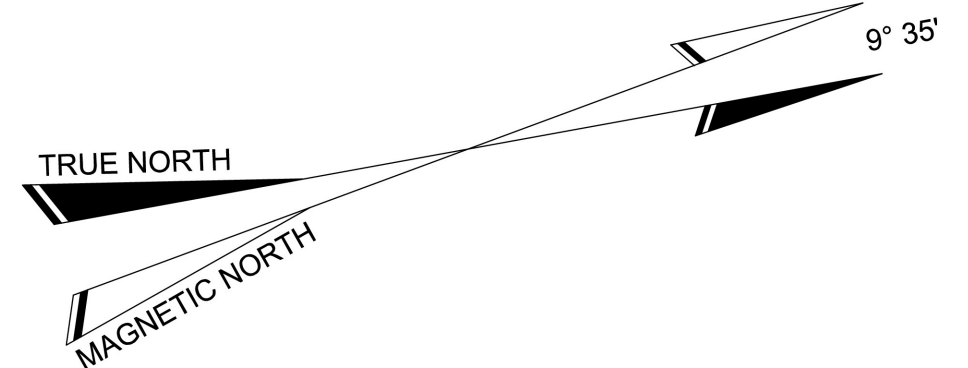

TOWNSHIP OF BRICK  
OCEAN COUNTY

BOROUGH OF MANTOKING  
OCEAN COUNTY

BOROUGH OF POINT PLEASANT  
OCEAN COUNTY

BOROUGH OF POINT PLEASANT BEACH  
OCEAN COUNTY

- R-50 SINGLE FAMILY RESIDENTIAL
- R-100 SINGLE FAMILY RESIDENTIAL
- R-100BF SINGLE FAMILY RESIDENTIAL, BAY FRONT
- R-100OF SINGLE FAMILY RESIDENTIAL, OCEAN FRONT
- B-1 GENERAL COMMERCIAL
- B-2 MARINE COMMERCIAL
- B&B BED & BREAKFAST
- C CONSERVATION

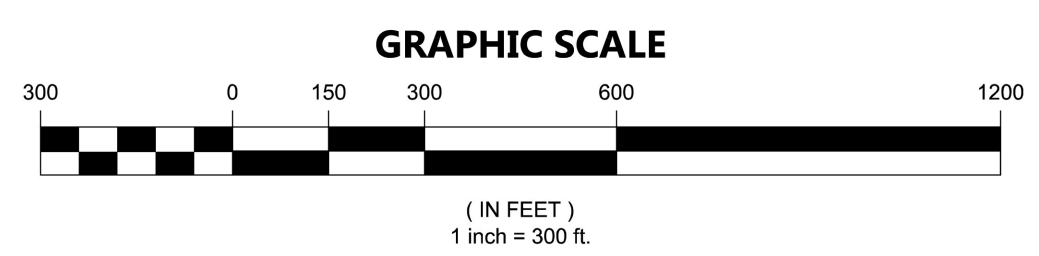

**ZONING MAP**  
**BOROUGH OF BAY HEAD**  
 OCEAN COUNTY, NEW JERSEY  
 SCALE: 1"=300' DATE: OCTOBER 2024  
 VAN CLEEF ENGINEERING ASSOCIATES  
 1705 ROUTE 37 EAST, TOMS RIVER, NJ 08753