

LAND DEVELOPMENT

240 Attachment 4

Borough of Oradell

Side Yard Wall Setbacks

Diagram C

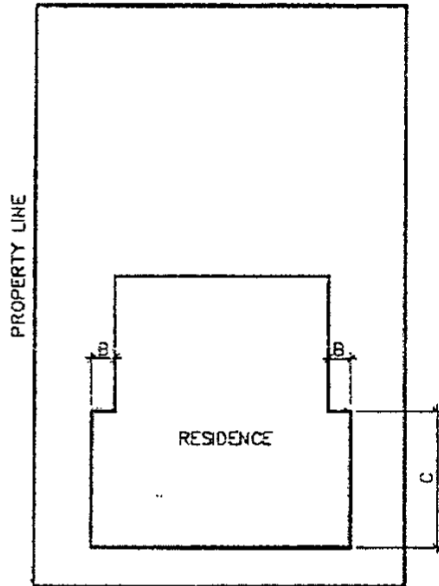

ZONE	OFFSET "B"	MAX WALL LENGTH "C"
R-1	6'	35'
R-2	6'	35'
R-3, R-4, R-5	2'	40'

A wall length along any side yard may not exceed the dimensions shown in Diagram C and shall be measured as a horizontal plane as defined below.

The measurement of a horizontal plane is the length of a building measured along the longest length of a wall surface on any single building face by projecting all wall surfaces, of all floors, vertically to the grade below.

For the purpose of Diagram C, the horizontal plane measurement shall be continuous through all projections from the walls for fireplaces chimneys, oriel windows such as bay, box bay or other similar ornamental projection of less than 15 feet in width. Those projections 15'0" in length or greater must be 2'0" or greater in depth and continuous in height to the intersecting point of the gable end or roof eave above to be considered as a separate horizontal plane measurement.

Open covered porches, decks and patios are not included in the length of wall calculation.

Date: 9-4-2012