

ZONING

450 Attachment 1

City of Las Vegas

Parking Lot Designs

Appendix A
Clear Sight Triangle

Corner Lot

Clear sight triangle applies to both corner lots and off-street multiple parking areas.
No obstructions over three feet in height shall be permitted within the clear sight triangle.

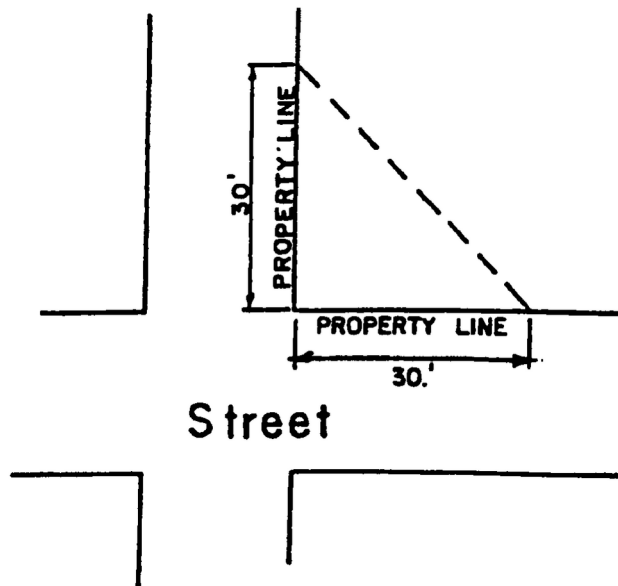

Off-Street Multiple Parking Areas

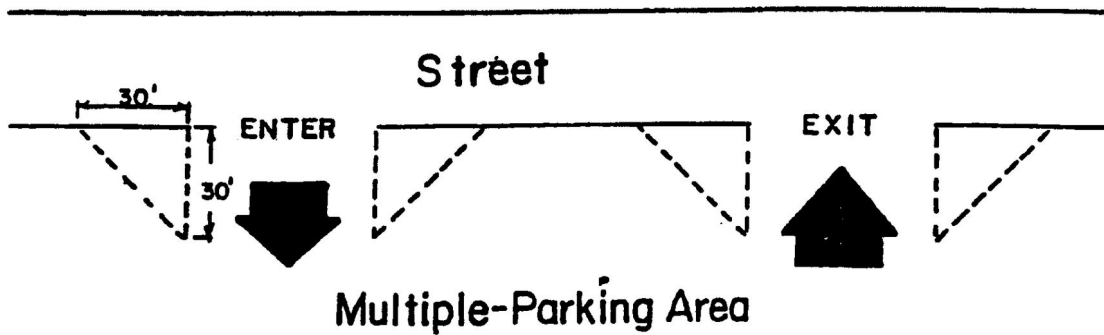

Appendix B
 Parking Layouts and Off-Street Traffic Flow Illustrations

Section 9.2

Dimensions shown below are for illustration purposes only and are subject to changes that may be required during review and approval.

PERMISSIBLE DESIGNS
 NO SCALE

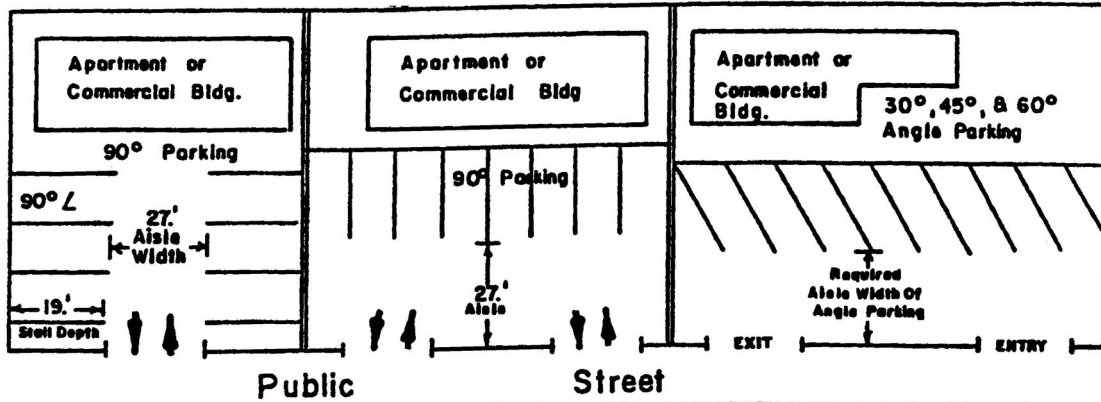

Two-way traffic permissible with forward entry and exit to a public street.

Two-way traffic permissible from 90° parking stalls.

One-way traffic only in this design with entry giving forward access to stalls and exit giving forward access in one direction.

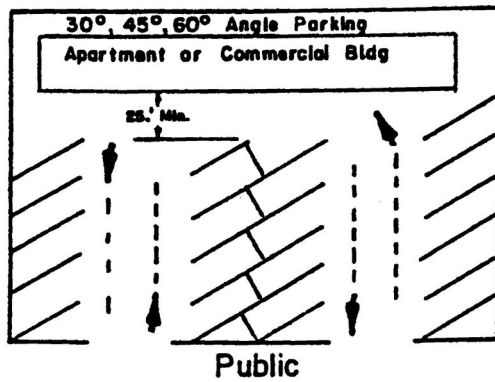

Two-way traffic and angle parking permissible as shown above where there is entry and exit from stalls in one forward direction.

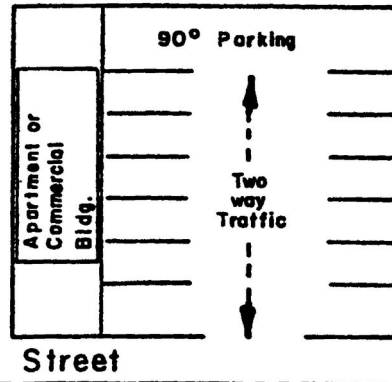

Two-way traffic is permissible where there is forward entry and exit to a public street.

ZONING

Appendix C
Permissible Designs Continued

Section 9.2 A-2

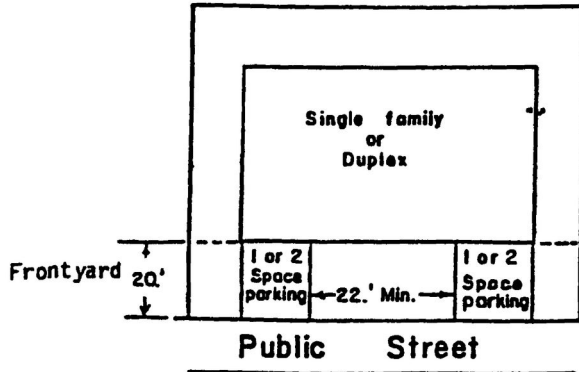

Backout parking is permitted for a single-family or duplex unit provided the required distance between curb cuts is maintained.

Section 9.2 A-1

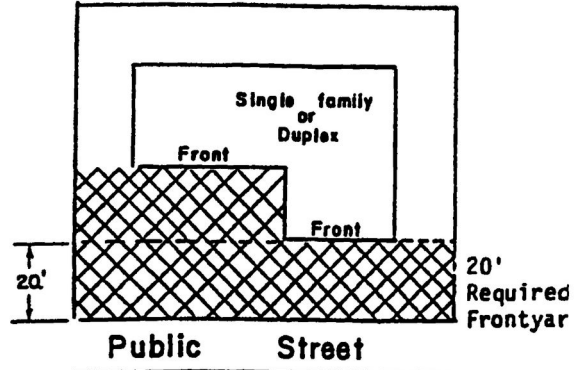

No more than 1/3 of any part of a yard to the front of a dwelling may be used for parking.

Aley

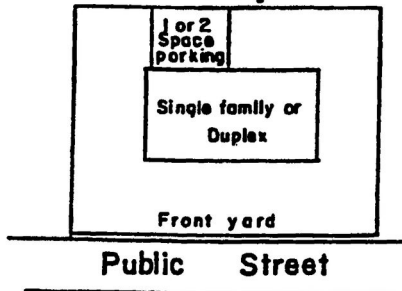

A maximum of a double parking space is permitted with access to alley