

# ZONING REGULATIONS

## 400 Attachment 1

### City of Ellisville

#### Appendix A: Typical Planting Details [Ord. No. 3559, 10-18-2023]

Figure 43: Typical Tree Planting Detail

**TREE PLANTING NOTES:**

1. SEE PLANS FOR TREE SPACING. USE CENTER OF PLANT FOR SPACING MEASUREMENTS.
2. EDGE OF PLANTING PIT TO BE 2-3x THE DIAMETER OF THE ROOTBALL.
3. WHEN CONTAINER PLANTS ARE USED, REMOVE PLANT FROM FIBER, METAL, PLASTIC, PAPER, ETC. CONTAINER IMMEDIATELY BEFORE PLANTING.
4. WHEN USING BALL & BURLAP PLANTS CUT AND LOOSEN TWINE AND BURLAP FROM TRUNK, REMOVE ALL NON-BIODEGRADABLE MATERIALS IMMEDIATELY PRIOR TO PLANTING. CUT AND FOLD DOWN BURLAP AND BASKET FROM TOP THIRD OF ROOTBALL.
5. PLACE ROOTBALL ON TAMPED OR UNEXCAVATED SOIL TO PREVENT SETTLING.
6. SET ROOTBALL 1-2" ABOVE GRADE TO ALLOW FOR SETTLING. DO NOT COVER ROOTBALL WITH SOIL.
7. ENSURE NO AIR POCKETS ARE FORMED WHEN BACKFILLING PLANTING PIT.
8. APPLY 3" MULCH IN A MINIMUM 6' DIAMETER RING AROUND TREE PLANTING. DO NOT APPLY MULCH IN CONTACT WITH TRUNK.
9. WATER PLANT THOROUGHLY IMMEDIATELY AFTER PLANTING.
10. NOTE: TREE STAKING SHOULD BE PROVIDED, AS NEEDED, TO PREVENT TREE MOVEMENT

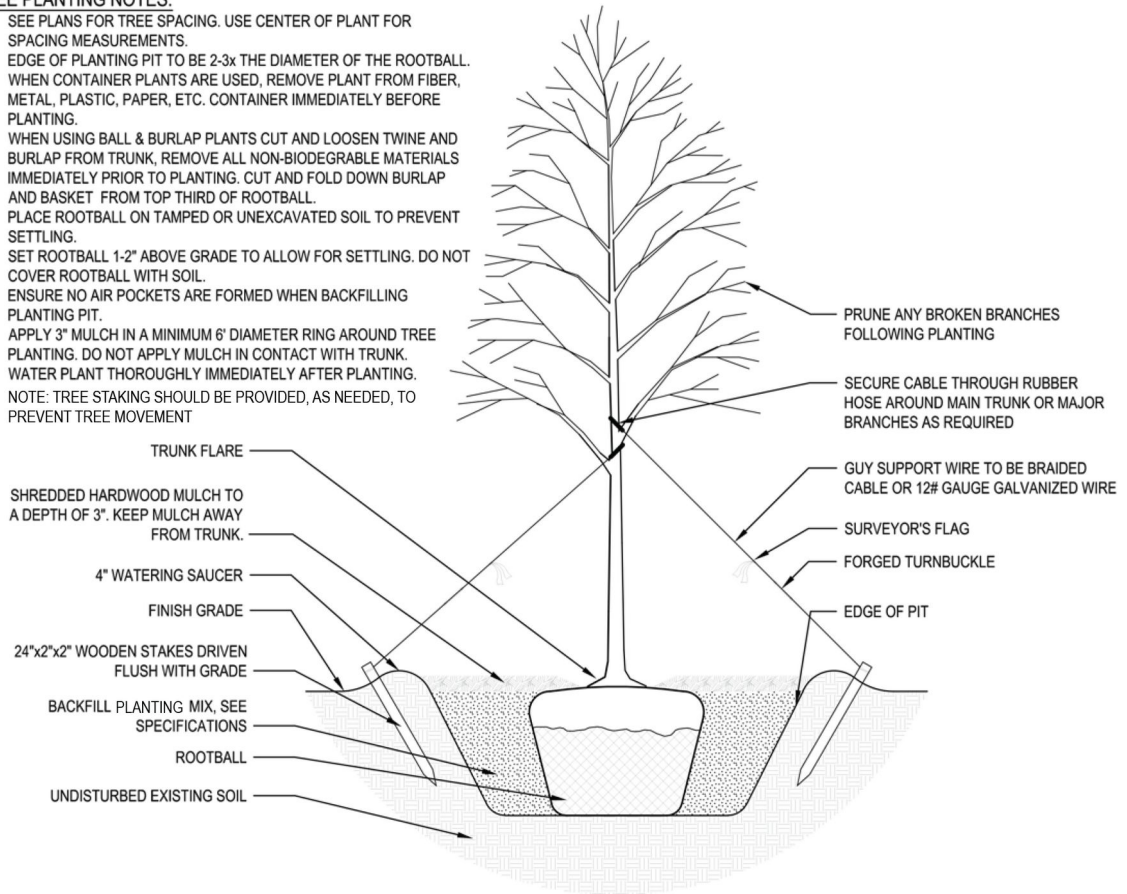

ELLISVILLE CODE

Figure 44: Typical Shrub Planting Detail

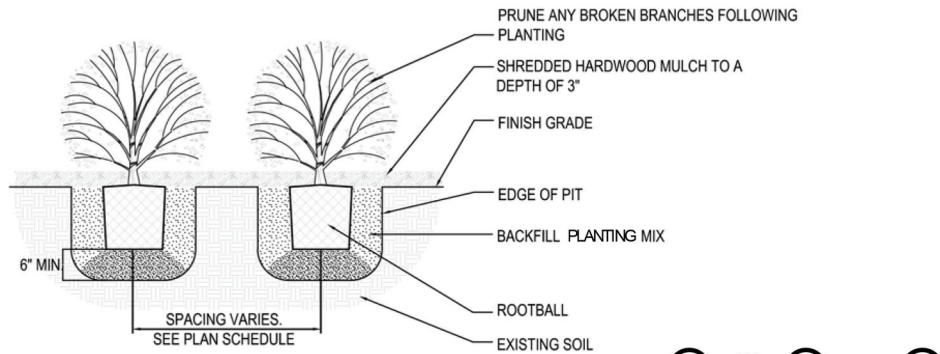

**SHRUB PLANTING NOTES:**

1. PLANT MASSINGS TO BE PLANTED IN A TRIANGULAR GRID PATTERN. SEE DETAIL.
2. EDGE OF PLANTING PIT TO BE 2x THE DIAMETER OF THE ROOTBALL. CREATE 4" WATERING SAUCER WHEN NOT PLANTED IN LAWN AREA.
3. WHEN PLANTED IN LAWN AREA HOLD LAWN BACK TO EDGE OF PIT.
4. WHEN CONTAINER PLANTS ARE USED, REMOVE PLANT FROM FIBER, METAL, PLASTIC, PAPER, ETC. CONTAINER IMMEDIATELY BEFORE PLANTING.
5. WHEN USING BALL & BURLAP PLANTS CUT AND LOOSEN TWINE AND BURLAP FROM TRUNK, REMOVE ALL NON-BIODEGRABLE MATERIALS IMMEDIATELY PRIOR TO PLANTING.
6. LIGHTLY TAMP BACKFILL UNDER ROOTBALL BEFORE PLANTING TO PREVENT SETTLING.
7. ENSURE NO AIR POCKETS ARE FORMED WHEN BACKFILLING PLANTING PIT.
8. WATER PLANT THOROUGHLY IMMEDIATELY AFTER PLANTING.

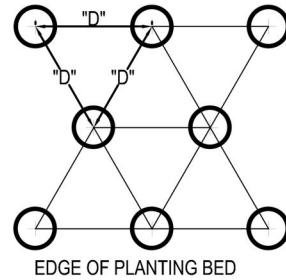

"D": PLANT SPACING DISTANCE

TRIANGULAR GRID LAYOUT

Figure 45: Typical Groundcover/Perennial Planting Detail

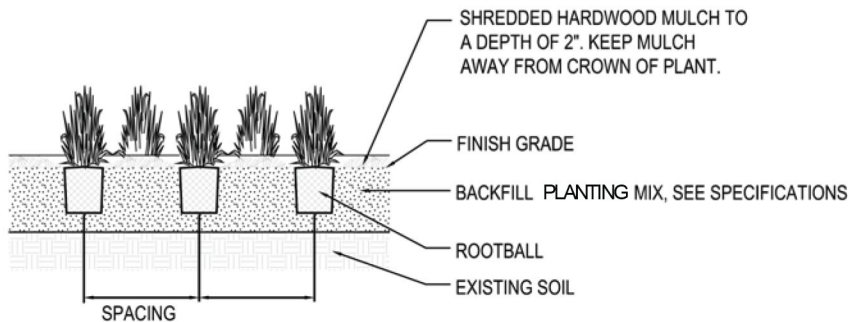

**GROUNDCOVER / PERENNIAL PLANTING NOTES:**

1. PLANT MASSINGS TO BE PLANTED IN A TRIANGULAR GRID PATTERN. SEE DETAIL.
2. REMOVE PLANT FROM FIBER, METAL, PLASTIC, PAPER, ETC. CONTAINER IMMEDIATELY BEFORE PLANTING.
3. EDGE OF PLANTING PIT TO BE 2x THE DIAMETER OF THE ROOTBALL.
4. GENTLY LOOSEN ROOTMASS IMMEDIATELY PRIOR TO PLANTING.
5. WATER PLANT THOROUGHLY IMMEDIATELY AFTER PLANTING.
6. PRUNE ANY SPENT FLOWERS OR DEAD/BROKEN STEMS FOLLOWING PLANTING